

PRECAUTION

In order to prevent operating problems or serious damage to the device, please comply with the following remarks:

1. Hold the electric outlet while pulling out the plug. Do not pull the wire.
2. Operating audio appliances should be kept away from heating facilities.
3. Do not attempt to fix or revise the circuit.
4. Do not touch the internal parts, otherwise electric shock or serious damage to the device might cause.
5. Pull out the plug if not in use for long.
6. Ensure the audio product in a ventilated dry condition with about 20mm space around as for heating dispersion.

Warning: Do not expose this appliance to rain or moisture, and vessel containing liquids, such as a cup, vase, is not supposed to be placed on or above the appliance.

TROUBLESHOOTING

Symptom	Possible Problem	Solution
No Function Light & No Sound	1. Plug is not well connected	Insert the plug into electric outlet
	2. Speaker power button is not turned on	Turn on the button
Function Light on but No Sound	1. Cable misconnected	Turn off the power, check the input jack to ensure proper audio signal is connected to relevant input jack
	2. Audio signal is not transmitted to speaker	Check all the speakers if there is audio signal output

If the problem exists after checking related procedures above, please refer to the appointed service agent or professional technician to fix it. Do not attempt to open the cover, otherwise we assume no responsibility.

ATALAX®

USER MANUAL



ICON

PROFESSIONAL SPEAKER

PLEASE READ THIS USER MANUAL CAREFULLY BEFORE SYSTEM CONNECT

MADE IN CHINA

IMPORTANT SAFETY MEASURES

Before using this machine, please read all the safety and operating instructions, meanwhile, please observe all the indications about safe operating. These safety and operating instructions should be kept in condition of consultation.

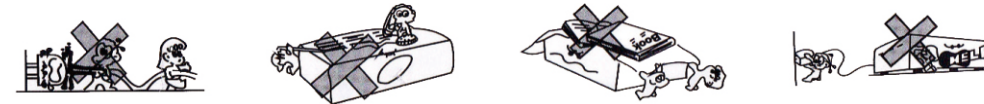

1. Protection of electric power supply line: Be aware that the electric power supply line is not trapped, pressed by heavy objects. Pay special attention to the plug of power supply line and outlet on the machine. DO NOT lengthen the electric shock, DO NOT pull or drag or the power supply line.
2. Ventilation: This set must be put in ventilated place. DO NOT put disk on it or cloth to cover it. The distance away from the wall should not be less than 10 centimeters. DO NOT put this set on the bed, sofa, carpet or other objects with similar surface in case of good ventilation.
3. Casing Dismantling: DO NOT dismantle the casing. If one touches the inner components, he will probably get serious electric shock.
4. Unusual smell: When you discover unusual smell and smoke, cut power supplies immediately and pulls out the plus from the outlet on the wall. Contact the sell shop or nearest repairing center.

Attention: This set applies to AC 110V/220V 50Hz~60Hz power supply. Use standard power supply. Please be sure for te correct power supply before use it.

PRODUCT FEATURES

1. High output power.
2. With Karaoke function.
3. The treble is clear, natural and bass is powerful.
4. Compatible to DVD/VCD/CD/TAPE/MP3/MP4/AUX.

FRONT PANEL FUNCTION INSTRUCTION

ICON

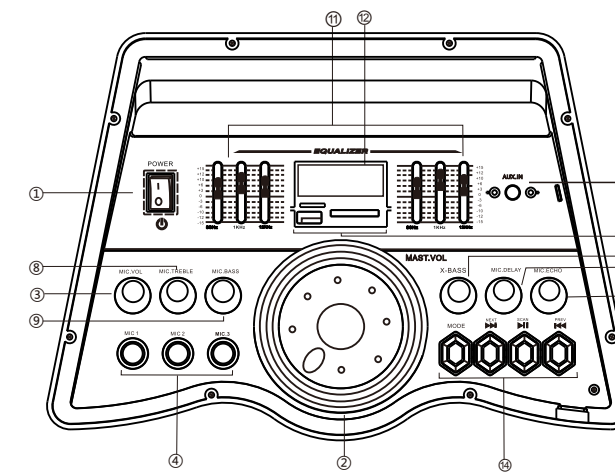

- ① POWER ON/OFF SWITCH
- ② MASTER VOL: MASTER VOLUME CONTROL
- ③ MIC. VOL: MICROPHONE VOLUME CONTROL
- ④ MIC 1/MIC2/MIC3: JACK 6.3MM MICROPHONE
- ⑤ MIC. DELAY: MICROPHONE DELAY CONTROL
- ⑥ AUX IN: JACK 3.5MM MP3
- ⑦ USB / TF / SD CARD SLOT
- ⑧ MIC. TREBLE: MICROPHONE TREBLE ADJUST KNOB
- ⑨ MIC. BASS: MICROPHONE BASS ADJUST KNOB
- ⑩ MIC. ECHO: MICROPHONE ECHO ADJUST KNOB
- ⑪ EQUALIZER
- ⑫ DISPLAY SCREEN
- ⑬ X-BASS VOLUME CONTROL
- MODE : USB / SD / LINE(AUDIO INPUT) / WIRELESS / FM SELECTION
- ⏪ : VOLUME INCREASE / NEXT
- ⏩ : PLAY / PAUSE
- ⏮ : VOLUME DECREASE / PREVIOUS

REMOTE CONTROL



- ⏻ Standby
- 📶 USB/SD/LINE (Audio input)
- ⏮ Prev/FM CH-
- ⏪ Play/pause/FM tuner
- ⏭ Next/FM CH+
- ⏹ Repeat
- ⏹ Stop
- ⏩ Volume up
- ⏮ Volume down
- ⏻ Mute
- ⚙ Equalizer
- 🔢 Number

WIRELESS USE INSTRUCTION

Change the mode into "BLUC", the wireless sign light twinkles, and speaker have sound "di". Set on mobile phone, connect to wireless data, search equipment and match properly. The proper connect wireless lights keep on, and music work on speaker normally.

BACK PANEL FUNCTION INSTRUCTION

1. AUDIO INPUT: DVD/TV or other AUX AV player audio signal input jack.
2. Switch for AUDIO INPUT, and switch for LED.
3. AC input: AC 110V/220V.

USE INSTRUCTION

1. Connect the signal cables according to the back panel connection instruction.
2. To sure the correct the voltage, insert electronic source cable, turn on the power switch button.
3. Adjust function keys to your satisfied best sound effect.

BACK PANEL CONNECTION DIAGRAM

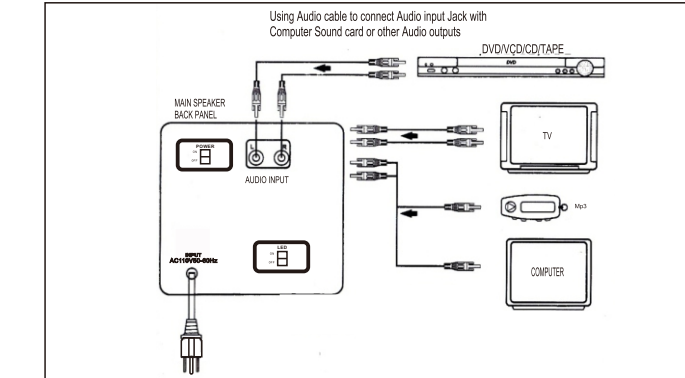

148.5mm

148.5mm

148.5mm

148.5mm

210mm

210mm